

# MetsäBoard Prime FBB EB

## PRODUCT SHEET



### Product description

Fully coated paperboard with dispersion barrier coating providing medium grease and moisture resistance, hard sized, OBA-free, free from fluorinated chemicals

### End use

Fresh food, Packages for selected food service, Dry food

### Features

Printing method Offset, Flexo, Digital  
 Food contact EU Regulation (EC) No 1935/2004, USFDA21CFR§176.170\*, USFDA21CFR§176.180\*, GB4806.8, GB9685

Metsä Board mill Kyro

### Structure

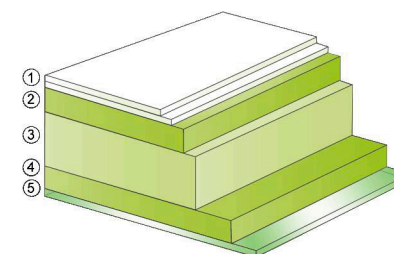

- 1) Double blade coating
- 2) Bleached chemical pulp\*\*
- 3) Bleached chemi-thermo-mechanical pulp (BCTMP)\*\*
- 4) Bleached chemical pulp\*\*
- 5) Dispersion barrier coating

PROPERTY, UNIT	METHOD	STANDARD	TOLERANCE	VALUES									
Grammage		ISO 536	± 4%	<b>200</b>	<b>215</b>	<b>225</b>	<b>235</b>	<b>250</b>	<b>270</b>	<b>285</b>	<b>325</b>	<b>350</b>	
Thickness µm		ISO 534	± 4%	305	330	355	385	415	455	485	565	600	
Bending stiffness CD (Taber 15°)	Taber 15°	ISO 2493-2	- 15%	3.4	4.1	4.9	5.9	7.3	9	10.4	13.7	16	
Bending stiffness MD (Taber 15°)	Taber 15°	ISO 2493-2	- 15%	8.2	10.2	11.6	14.2	17.3	21.2	24.5	30.3	37.4	
Moisture content %		ISO 287	± 1.0	7.0	7.0	7.0	7.2	7.5	7.7	7.8	8.3	9	
Smoothness top µm	PPS10	ISO 8791-4	max 1.5	1.5	1.5	1.5	1.5	1.5	1.5	1.5	1.5	1.5	
Brightness top %	Illumination C/2°	ISO 2470-1	± 1	85	85	85	85	85	85	85	85	85	
Off-flavour (Robinson test)	12 mo in orig. pack	EN 1230-2		< 1	< 1	< 1	< 1	< 1	< 1	< 1	< 1	< 1	

Tolerances, when specified, are based on 95% confidence limits on mill measurements of samples tested in standard conditions (23°C/50% RH).

Metsä Board Paperboard mills have FSC® / C001580 and PEFC / 02-31-92 CoC certificates.

\*Please contact Metsä Board for details of grammage and / or country-specific, restrictions and limitations.

Issued 01.02.2024. Supersedes sheet dated 02.07.2020.