

MetsäBoard Pro FSB Cup 1PE 0/18

PRODUCT SHEET



Product description

Food service board, top coated, hard sized, OBA free, PE coating on reverse side (matt)

End use

Cold drink cups, Ice cream cups, Ice cream containers, Bowls, Trays, Containers

Features

Printing method Offset, Flexo, Gravure
 Food contact Suitable for food contact*
 Metsä Board mill Husum

Structure

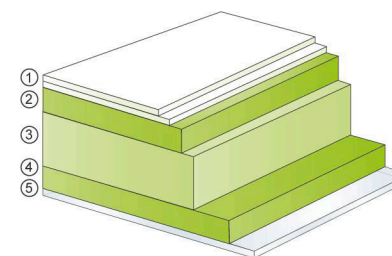

- 1) Double blade coating
- 2) Bleached chemical pulp
- 3) Bleached chemi-thermo-mechanical pulp (BCTMP) + chemical pulp
- 4) Bleached chemical pulp
- 5) PE coating

PROPERTY, UNIT	METHOD	STANDARD	TOLERANCE	VALUES							
Grammage total g/m ²		ISO 536		223	238	253	273	283	298	323	348
Thickness total µm		ISO 534		277	297	332	357	382	397	437	477
Grammage PE reverse g/m ²		ISO 536		18	18	18	18	18	18	18	18
Baseboard property, unit											
Grammage g/m ²		ISO 536	± 4%	205	220	235	255	265	280	305	330
Thickness µm		ISO 534	± 4%	260	280	315	340	365	380	420	460
Bending stiffness CD mNm	Taber 15°	ISO 2493	- 15%	2.7	3.5	4.3	5.2	6.4	7.5	9.0	11.9
Bending stiffness MD mNm	Taber 15°	ISO 2493	- 15%	5.2	6.9	8.9	10.8	13.8	15.3	19.5	27.8
Moisture content %		ISO 287	± 1.0	8.0	8.0	8.0	8.5	8.5	8.5	9.0	9.0
Smoothness top µm	PPS10	ISO 8791-4	max 1.6	1.6	1.6	1.6	1.6	1.6	1.6	1.6	1.6
Brightness top %	Illumination C/2°	ISO 2470-1	± 1	85	85	85	85	85	85	85	85
Stretch CD %		ISO 1924-3		5.0	5.0	5.0	5.0	5.0	5.0	5.0	5.0
Off-flavour (Robinson test)	12 mo in orig. pack	EN 1230-2		< 1	< 1	< 1	< 1	< 1	< 1	< 1	< 1

Tolerances, when specified, are based on 95% confidence limits on mill measurements of samples tested in paperboard manufacturing conditions.

Metsä Board Paperboard mills have FSC® / 02-31-92 and PEFC™ / C001580 CoC certificates.

*Please contact Metsä Board for details of grammage and / or country-specific, restrictions and limitations.

Issued 02.07.2020. Supersedes sheet dated 01.01.2020.